

S.W. 1/4
SECTION 8, T.6N., R.1W., S.L.B. & M.

IN OGDEN CITY & TOWN OF HARRISVILLE

TAXING UNIT: 20, 25

SCALE 1" = 200'

ALSO SEE PAGES 42-1, 2, 3,

SEE PAGE 33

TAYLOR RANCHETTES SUB.
SEE PAGE 246

CROPSY 3RD.
ADDITION
SEE

RADIUS ST.
P.
39

HART SUB. NO. 1
SEE P. 216

FIVE "T" CORP = 1/2
& REGENCY DEV LC = 1/2
110420030
4.49 AC±
TU:20

FIVE "T" CORP = 1/2
& REGENCY DEV LC = 1/2
110420031
2.52 AC±
TU:20

FIVE "T" CORPORATION = 1/2
& REGENCY DEV LC = 1/2
110420027
14.80 AC±
TU:20

CHRIS BOURNAKIS
& LITSA BOURNAKIS
110420028
9.62 ACRES±
TU:20

SEE P.
42-3

SEE P.
42-3

SEE P. 38

SEE PAGE 36

WAYNE TAYLOR
110420032
TU:20

HARRISVILLE TOWN LIMITS
OGDEN CITY LIMITS

OGDEN CITY
(110420034)
8.956 SQ FT

NORTH

STREET

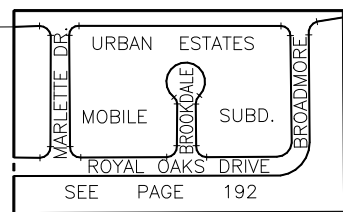

SEE P. 25

SEE P. 42-2

SEE P. 42-1

SEE

P. 43

DAN STREET

PARKWOOD ESTATES
NO. 1
PINGREE STREET
SEE PAGES 155 & 156